



# BX1695

## 2011-14 Chevy Cruze LS/1LT/2LT/LTZ

(Includes Fog Lights)

### Installation Instructions

**Attachment Tab Height: 14-1/4"**

**Attachment Tab Width: 20"**

**Serial Number**

**Please read BOTH these Installation Instructions and the General Instructions prior to installing or operating this equipment.**

- Blue Ox® towing products and accessories are intended to be installed by Blue Ox® Dealers who are familiar with our products and have the equipment and knowledge necessary to do "fit work". If needed, Blue Ox® Dealers can be found at [www.blueox.com](http://www.blueox.com) or by contacting our Customer Care Department at (402) 385-3051.
- Many Blue Ox® baseplates are designed to use existing holes and hardware to mount the baseplate to the towed vehicle. Even though bolts are there, do not assume they are adequate for baseplate mounting. Always use the hardware supplied in the hardware kit and existing hardware as specified in the installation instructions.

#### Bolt Torque Specifications

Torque in Foot-Pounds for Inch Bolts

Bolt Size	Grade 5	Grade 8
1/4"	10	14
5/16"	19	29
3/8"	33	47
7/16"	54	78
1/2"	78	119
5/8"	154	230
3/4"	257	380



If the front of your vehicle looks different than this, please contact us at (402)385-3051.

**Reference your vehicle owner's manual for manufacturer's towing specifications.**

#### Bolt Torque Specifications

Torque in Foot-Pounds for Metric Bolts

Bolt Size	Grade 8.8	Grade 10.9
6MM	6	8
8MM	16	22
10MM	31	40
12MM	54	70
14MM	89	117
16MM	161	230
18MM	222	318



## WARNING

Failure to read and follow these instructions could result in separation of the towed vehicle from the tow bar, causing property damage, loss of towed vehicle, personal injury or death.

BX1695  
2011-14 Chevy Cruze LS/1LT/2LT/LTZ  
(Includes Fog Lights)  
Installation Instructions

ITEM NO.	PART NUMBER	DESCRIPTION	QTY.
1	61-6812	WLDMT, BP, BX1695	1
2	61-6813	WLDMT, SUPPORT, DS, BX1695	1
3	61-6814	WLDMT, SUPPORT, PS, BX1695	1
4	61-5208	WLD, NUT PLATE, 1/4 X 1 X 1 3/8-16w/ 14" WIRE	8
5	62-3469	ATT TAB ASSY, REM. SF/8, 1 HOLE	2
6	201-0440	3/8-16 X 1 1/2" HEX BOLT, GRD. 5, ZP	4
7	201-0444	3/8-16 X 2 HEX BOLT GRADE 5 ZP	6
8	203-0010	3/8" LOCK WASHER, ZP	10
9	202-0090	3/8-16 HEX NYL INS. LOCK NUT, ZP	2
10	201-0553	1/4-20 X 1/2" HEX WASHED, TYPE F, ZP	2
11	201-0192	#10-32-1/2" SLOT, ROUND HEAD SCREW	2
12	203-0054	#10-32 LOCK WASHR, ZP	2
13	202-0047	#10-32 HEX NUT	2
14	101-5822	ADAPTER, 4 WAY CONNECTOR	2
15	102-7056	BREAKAWAY BRKT, BX1689	1
16	201-0654	#10-16 X 1" SELF DRILLING SCREW, ZP	1
17	201-0050	1/4-20 X 3/4 HEX BOLT, GRD. 5, ZP	1
18	202-0102	1/4-20 HEX NYL NUT, ZP	1
19		EXISTING METRIC BOLT	2

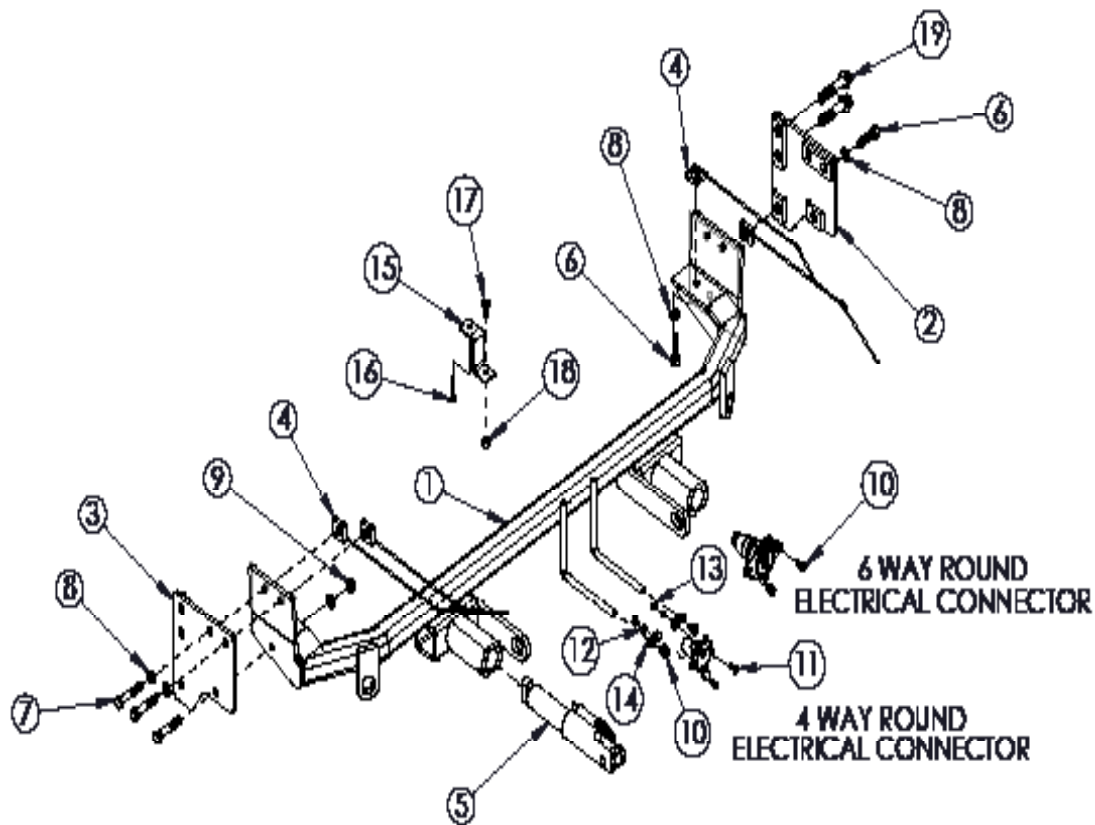

**Important:**

Use only genuine factory replacement parts on your baseplate. Do **NOT** substitute homemade or non-typical parts. If a bolt is lost or in need of replacement, for your safety and the preservation of your baseplate, be sure to use a replacement bolt of the same grade (In most cases it will be Grade 5, please reference the parts list above). Replacement parts may be ordered through your nearest Blue Ox® Dealer or Distributor. Failing to follow and/or altering these installation instructions in either installation or required equipment will void the manufacturer's warranty.

BX1695  
2011-14 Chevy Cruze LS/1LT/2LT/LTZ  
(Includes Fog Lights)  
Installation Instructions

**Attachment Tabs:** Motorhome mount tow bars are recommended for use with this baseplate. Due to the design of the removable tabs, the RangeFinderII, Acclaim, and Ambassador tow bars can not be used. Adapters, except the BX8833 and BX88151, can not be used with this baseplate.

**Instructions:** The front fascia, horn bracket and belly pan are removed for baseplate installation. Drilling is required. Trimming of air dam is required.

The dimensional variations between otherwise identical vehicles can be considerable. While the baseplate was designed for easy installation, it may be necessary to tailor the baseplate slightly to compensate for auto manufacturer's tolerances. These minor adjustments may include filing a hole slightly, bending electrical rods or bending end plates.

The BX8869 Bulb and Socket Wiring Kit is available for this vehicle.



**Possible Location of the BX8869 Bulb & Socket Wiring Kit**

**Do not use the towed vehicle for storing luggage, equipment, etc. This may cause you to exceed the towing capacity of the tow bar, baseplate, and its accessories.**

**Installation Instructions:**



1. Remove the two push pins (white arrows) from the black plastic cover just above the radiator. Using a 10MM socket, remove the metric bolt in the corner (gray arrow). Do this on both sides.



2. Just forward of front tire, on edge of wheel well, are three bolts to remove with the T20 torx, both sides.

Handling of some cosmetic parts when installing this product may require the use of protective covers, rags, specialty tools, etc. to prevent damage.



BX1695  
2011-14 Chevy Cruze LS/1LT/2LT/LTZ  
(Includes Fog Lights)  
Installation Instructions



3. Remove the two bolts from underneath the fascia, just forward of front tires with the T20 torx, both sides. Set bolts aside to be reinstalled later.

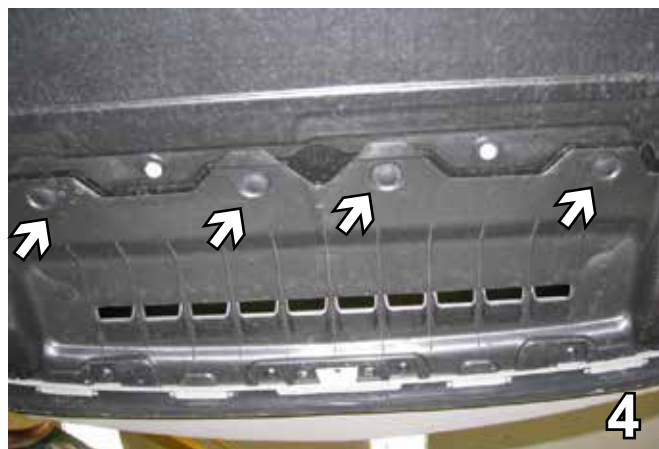

4. Remove the four push pins from underneath the fascia. Remove the fascia. Set aside push pins and fascia carefully to be reinstalled later.



5. Remove one push pin from the bottom of the belly pan. Do this on both sides. Set push pin aside to be reinstalled later.



6. Inside the wheel well, remove two push pins. Do this on both sides. Set push pins aside to be reinstalled later.

7. Using an 8MM socket, remove two metric bolts across the front of the belly pan and another across from the tire. Do this on both sides. Set bolts aside to be reinstalled later.



BX1695  
2011-14 Chevy Cruze LS/1LT/2LT/LTZ  
(Includes Fog Lights)  
Installation Instructions



8. Using an 8MM socket, remove one more metric bolt toward the back of the belly pan. Do this on both sides. Set bolt aside to be reinstalled later.



9. Using the 13MM socket, remove the metric bolt from the horn bracket on the driver's side, unplug and set the bolt and horn aside to be reinstalled later.



10. On the passenger side, remove the plastic ledge from the top of the tube. Set aside to be reinstalled later.



11. Using a 10MM socket, remove the metric bolt from the top of the air intake tube. Set the bolt and the tube aside to be reinstalled later.



12. Cut the plastic air dam along the top, even with the bottom of the bumper and remove. Do this on both sides.



BX1695  
2011-14 Chevy Cruze LS/1LT/2LT/LTZ  
(Includes Fog Lights)  
Installation Instructions



13. Cut frame webbing in these three locations with a reciprocating saw. Do this on both sides.



14. Using vice grips, bend the metal edge over and flatten with a hammer. Do this on both sides.



15. Using an 18MM socket and a wrench on the other side, remove the two metric bolts next to the flattened area. Do this on both sides. Set bolts aside to be reinstalled later.



16. Using the 1 1/2" hole saw, drill a hole in the bumper centered with the frame, just in front of the frame end. Do this on both sides.

**When using power drills be aware of the dangers of torque and drill bit length.**

17. Slide the baseplate on to the frame rail flush with the top and clamp the baseplate to the frame rail with the vise grip.



BX1695  
2011-14 Chevy Cruze LS/1LT/2LT/LTZ  
(Includes Fog Lights)  
Installation Instructions



18. Using the baseplate as a template, drill a hole underneath with the 13/32" drill bit. Insert 3/8-16 x 1 1/2" hex bolts with Loctite and 3/8" lock washers attached to 3/8-16 nut plates through 1 1/2" lower opening on bumper. Do this to both sides.



19. Inside the 1 1/2" drilled hole is a cross piece which may need to be bent vertically in order to insert 3/8" nut plate. Do this on both sides.

**BE SURE TO USE LOCTITE® RED ON ALL BOLTS BEFORE TIGHTENING. TIGHTEN ALL BOLTS ACCORDING TO THE TORQUE CHART ON THE FRONT PAGE OF THESE INSTRUCTIONS OR ON PAGE 3 OF THE BASEPLATE GENERAL TOWING INSTRUCTIONS.**

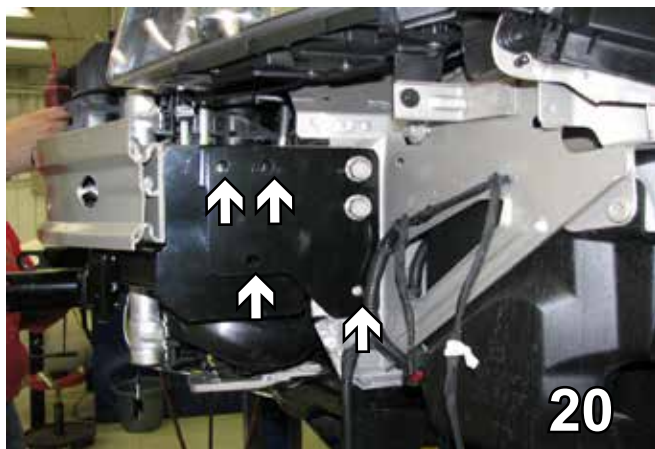

20. Bolt the support plates to the existing holes on the inside with the existing bolts. Use 18MM socket and a wrench on the other side to tighten bolts. Using the support plate as a template, drill the other four holes with a 13/32" drill bit. Do this on both sides.



21. Bolt the upper two holes (white arrows) with 3/8-16 x 2" hex bolts with 3/8" lock washers fasten to 3/8" nut plates inserted through the drilled hole in the bumper. In the lower outside hole (gray arrow) bolt the support plate to the baseplate with 3/8-16 x 2" hex bolts fastened with 3/8" lock washers and 3/8-16 hex nuts. Be sure to use Loctite on all bolts. Do this on both sides.



BX1695  
 2011-14 Chevy Cruze LS/1LT/2LT/LTZ  
 (Includes Fog Lights)  
 Installation Instructions



22. Insert 3/8-16 x 1 1/2" hex bolt with 3/8" lock washer into the lower back hole on the baseplate. Fasten to a 3/8" nut plate inserted through an existing hole underneath in the frame. Do this on both sides. Be sure to use Loctite on the bolts.



23. On the passenger side, drill a 1/4" hole below the big hole and pop the clip back in. Be sure it is low enough so that the line misses the baseplate. Reattach the horn bracket on the driver's side.



24. Attach the permanent baseplate safety cables to the provided convenience link on the front of baseplate (gray arrow). The photo above shows the recommended installation of the cables to lower cross member of vehicle (white arrow). Additional options may interfere with suggested mounting; in this case secure the cables to a solid piece of the frame as described in the instructions included with the permanent baseplate safety cables. Be sure the safety cables do not rub against any hoses or moving parts. Do this to both sides of the vehicle.

26. Location for the 4 or 6 pin electrical coupler on the fascia's lower air dam just below license plate.



25. Attach the breakaway bracket to the bottom of the bumper between two fascia ribs with two 10-16 x 1" self drilling screws. Attach the breakaway to the bracket with 1/4-20 x 3/4" bolt and 1/4-20 hex nut.





BX1695  
2011-14 Chevy Cruze LS/1LT/2LT/LTZ  
(Includes Fog Lights)  
Installation Instructions

Install the tow bar and safety cables according to the instructions included in their packages.

Do **not** substitute other devices if the tow bar pin and clip are lost.

**DEALER OR INSTALLER: BE CERTAIN THE USER RECEIVES THE INSTRUCTION SHEET.**



If the baseplate is in an accident, it must be replaced. DO NOT use it again! An accident can cause unseen damage and using it again could result in more damage or serious injury. DO NOT use the baseplate if it is damaged or missing parts.

**Be sure that ALL electrical connections are plugged in properly and functioning BEFORE Installing the fascia.**

## CUSTOMER SERVICE COMMITMENT

Blue Ox is committed to providing you with exceptional customer care throughout your lifetime with our products. Our team is here to assist you with any questions you may have regarding the performance of your product. Simply call (402) 385-3051 and you can speak with our customer care team.

Additionally, please visit our website to see which rallies our Destination America team will be attending. For a nominal fee, our service technician will service your towing system to ensure it's in proper working condition. Also, as a commitment to our customers, should you visit our factory, you can stay at our full service Blue Ox campground at no charge along with enjoying a factory tour.

Again, thank you for being our customer and for the confidence you have shown in the performance of our products. It is because of customers like you we enjoy the success we have today.



© 2011 Blue Ox  
One Mill Road, Industrial Park  
Pender, Nebraska 68047  
Phone: (402) 385-3051 • Fax: (402) 385-3360  
[www.blueox.com](http://www.blueox.com)

# General Information

1. Ensure that your product(s) are registered online at [www.blueox.com](http://www.blueox.com). It is crucial to register your product(s) so that you may be alerted of product offerings, updates, upgrades, maintenance and safety bulletins, and/or recalls.
2. **It is the owner's responsibility to inspect all towing equipment for cracked welds, missing or worn parts and loose bolts before each towing trip.** Be sure to use Loctite® Red on all bolts and tighten to the recommended specifications.
3. **It is the owner's responsibility to hook up all towing equipment per manufacturer's instructions/recommendations.**
4. Remove the attachment tabs when not in use (if applicable).

## Notice To Baseplate Installer

### 1. It is YOUR responsibility to watch for:

- Oil cooler and air conditioner lines
- Electrical wires and hoses
- Missing parts or attaching points on the frame

\*\* If the baseplate is improperly installed and is against a wire or hose, it could cause fluid leaks or electrical shorts some time after the actual baseplate installation.

## Permanent Baseplate Safety Cable Installation

Permanent baseplate safety cables are strongly recommended when towing a vehicle with a tow bar. The principle function of the permanent baseplate safety cables is to prevent the towed vehicle from breaking loose in the event the connection between the frame of the towed vehicle and the baseplate fails or becomes disconnected. The cables must be connected from the baseplate to the frame rail or cross member of the vehicle's frame. The illustrations below show the possible arrangements recommended by Blue Ox®. Each permanent baseplate safety cable must have an adequate weight rating for the towing system. The weight rating of the two (2) cables together will not qualify.

***Do not mount the permanent baseplate safety cables against wires, hoses or brake lines.***

These permanent baseplate safety cables should remain installed as long as the baseplate is installed on the vehicle. Permanent baseplate safety cables are to be used in conjunction with, and NOT a replacement for legally required safety cables attaching the towed vehicle to the towing vehicle.

### OPTION #1

Permanent Baseplate Safety Cables to Cross Member or Frame of Towed Vehicle.

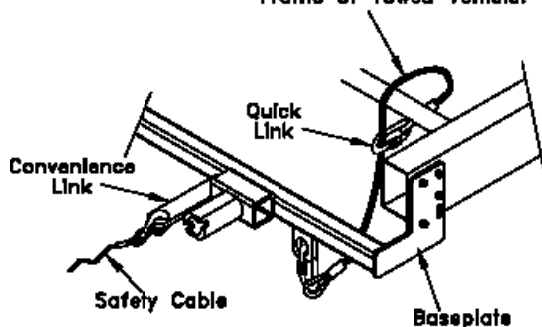

### OPTION #2

Permanent Baseplate Safety Cables to Cross Member or Frame of Towed Vehicle.

