



BX2511 Installation Instructions 1995-98 Mazda Protege

Utilization of Blue Ox baseplates with any tow bar not approved by Automatic Equipment Mfg. Company invalidates the limited warranty.

Installation of this baseplate requires removing the bumper cover, the grill, the amber blinkers, and the headlights.

1. Read the General Instruction Sheet included with this baseplate.
2. The bumper cover and grill must be removed to install the baseplate. There is a black plastic cover over the top center of the radiator. It is held on by six plastic rivets. To remove the rivets, give the center a quarter turn with a screwdriver and the center will pop-up. The rivet can then be pried out of the hole. The center grill snaps onto four plastic "towers". To release the grill there are square holes in the top of the "towers". Push in with a screwdriver and pull out on the grill to release each tower.
3. The amber blinkers and headlights will need to be removed before the bumper cover can be taken off. The amber lights have to be taken off first. There is a phillips head screw on the top outside corner of the headlight assembly which attaches the light. Remove the screw and pull the amber assembly forward to remove. There is a snap catch which will "pop" loose as you pull the light assembly forward. There are three bolts and a nut that bolt the headlight assembly to the car. Remove the bolts and loosen the nut. The assembly does not need to be completely removed, as you can gain access to the two phillips head screws by moving it aside.
4. Remove the two screws under each headlight and the two screws in the top center of the bumper cover. In each fender well there are three plastic rivets. The bumper cover is attached to the fender at the tip of the bumper cover. You will need to pull the fender well skirt back to gain access to the screw. In the top of the center opening there is a large plastic rivet. The center screws out and then the outside can be pried out. On the bottom of the car there is a black splash guard held on by six bolts. You will need a 10mm wrench. Just outside of the splash guard there is a phillips screw on each side. With all of these removed the bumper cover will slide forward and off the car.
5. On the outside of the frame on each side of the car you will see a shipping tie down plate bolted to the car with four bolts. The baseplate bolts to the car using three of the four bolts. Remove the lower two and the front bolt from each tie down. The tie down plate will remain on the car. Set the bolts aside, the bolts supplied with the baseplate will be used to mount the baseplate.
6. On the driver's side of the bumper there is a black plastic piece attached to the bumper. Remove the piece and set it aside, it must be left off while the baseplate is installed.
7. Slide the baseplate over the tie down plates and start the 10mm bolts, lock, and flat washers into the car. Apply Loctite to the bolts. When all bolts are started, tighten completely.
8. Replace the bumper cover and lights by reversing the Steps 2 thru 4.
9. The dimensional variations between otherwise identical cars can be considerable. While the location and size of the holes in the baseplate were designed to allow for easy installation, it may be necessary to file a hole slightly to allow a bolt to clear.
10. Install the tow bar and safety cables according to the instructions included in their packages.

Automatic

11. Do not substitute other devices if the tow bar pin and clip are lost.

12. DEALER OR INSTALLER: BE CERTAIN THE USER RECEIVES THE INSTRUCTION SHEET.

Tools Required

10mm Socket
8mm Socket
Loctite Blue

14mm Socket
Phillips Screwdriver

17mm Socket
Flat Screwdriver

Parts List

Ref. No.	Qty.	Part No.	Description
1	1	61-5125	Weldment, Baseplate, BX2511
2	6	201-0423	10mm-1.25 x 35mm Hex Bolt, Grade 8.8
3	6	203-0003	3/8 Flat Washer
4	6	203-0104	10mm Lock Washer

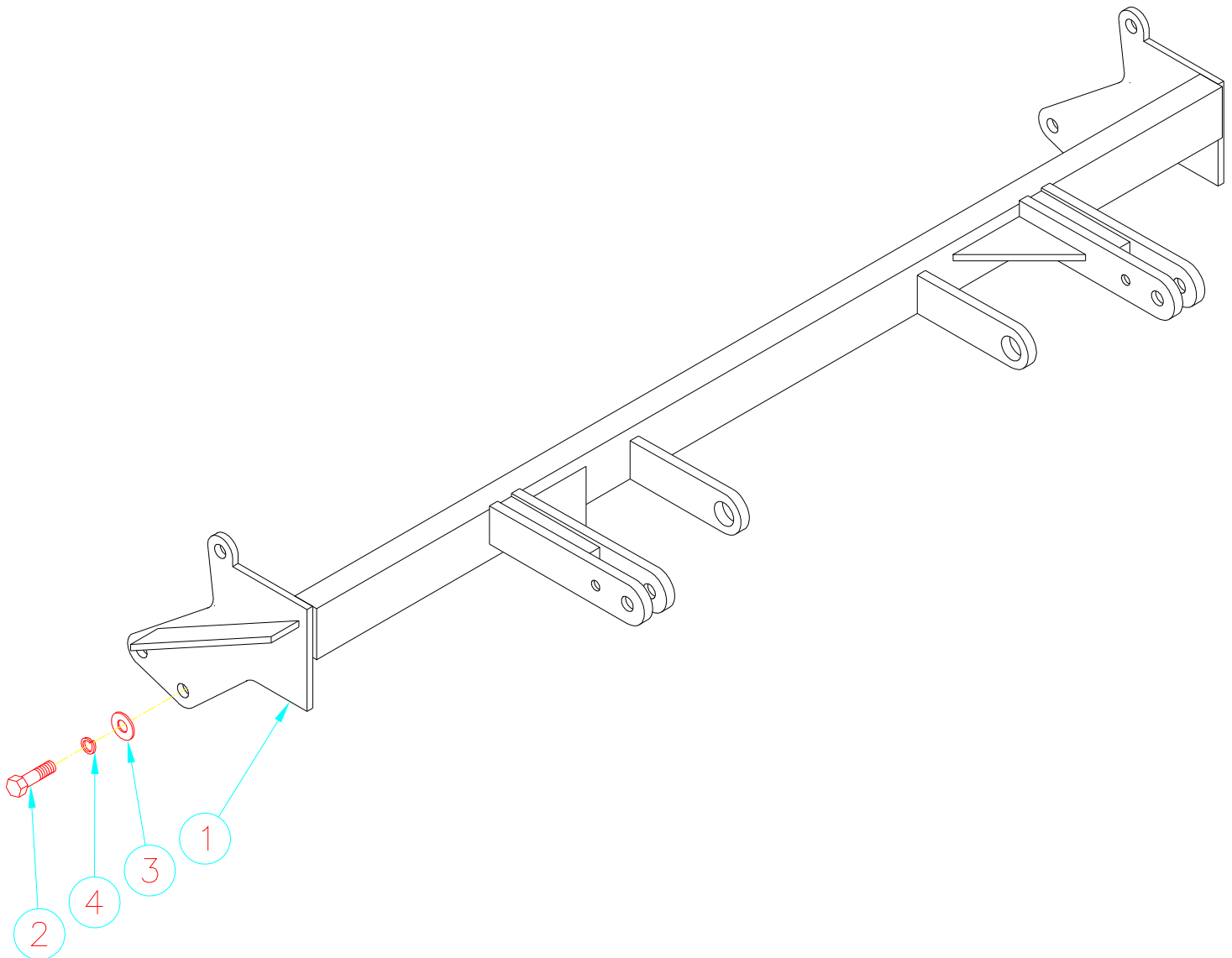

General Information

1. Ensure that your product(s) are registered online at www.blueox.com. It is crucial to register your product(s) so that you may be alerted of product offerings, updates, upgrades, maintenance and safety bulletins, and/or recalls.
2. **It is the owner's responsibility to inspect all towing equipment for cracked welds, missing or worn parts and loose bolts before each towing trip.** Be sure to use Loctite® Red on all bolts and tighten to the recommended specifications.
3. **It is the owner's responsibility to hook up all towing equipment per manufacturer's instructions/recommendations.**
4. Remove the attachment tabs when not in use (if applicable).

Notice To Baseplate Installer

1. It is YOUR responsibility to watch for:

- Oil cooler and air conditioner lines
- Electrical wires and hoses
- Missing parts or attaching points on the frame

** If the baseplate is improperly installed and is against a wire or hose, it could cause fluid leaks or electrical shorts some time after the actual baseplate installation.

Permanent Baseplate Safety Cable Installation

Permanent baseplate safety cables are strongly recommended when towing a vehicle with a tow bar. The principle function of the permanent baseplate safety cables is to prevent the towed vehicle from breaking loose in the event the connection between the frame of the towed vehicle and the baseplate fails or becomes disconnected. The cables must be connected from the baseplate to the frame rail or cross member of the vehicle's frame. The illustrations below show the possible arrangements recommended by Blue Ox®. Each permanent baseplate safety cable must have an adequate weight rating for the towing system. The weight rating of the two (2) cables together will not qualify.

Do not mount the permanent baseplate safety cables against wires, hoses or brake lines.

These permanent baseplate safety cables should remain installed as long as the baseplate is installed on the vehicle. Permanent baseplate safety cables are to be used in conjunction with, and NOT a replacement for legally required safety cables attaching the towed vehicle to the towing vehicle.

OPTION #1

Permanent Baseplate Safety Cables to Cross Member or Frame of Towed Vehicle.



OPTION #2

Permanent Baseplate Safety Cables to Cross Member or Frame of Towed Vehicle.

