



BX4002 Installation Instructions 2003 Volvo V70

Serial No.

Strong As An Ox™

Drilling is necessary. Trimming of the fascia is needed. The BX8869 is available for this vehicle. Attachment tabs are 20 inches center to center and a height of 14 1/2 inches. **Be sure to use loctite on all bolts before tightening. Tighten all bolts according to torque chart in general instruction sheet.**



1. Remove the six push pins at the top of the fascia with a screw driver (pushing down in the middle of pin).
2. Remove the head light wipers using 8mm socket and unplug wiper hose.



3. Remove the 25mm Torx bolt in the wheel well in front of the tire. Loosen bolt, then push in to release.
4. On the front of the car, remove two 12mm bolts to remove plastic piece and styrofoam.



5. The plastic piece below the radiator needs to be removed. Remove two 10mm bolts, one on each side.
6. On the same plastic piece, using a flat screwdriver, flip the tabs through the slots.



Strong As An Ox™



7. With one person holding the baseplate in place, use two 1/2-13 x 1 3/4 hex bolts, lock washers, and 1/2-13 nutplates, one on each side using existing holes (item 6, 9 and 4) as shown in above picture. **Note: Don't tighten completely.**



9. Drill the other two holes into the frame with a 17/32" drill bit for the 1/2-13 bolt, and 13/32" drill bit for the 3/8-16 bolt on both sides. With the four holes drilled, use two 1/2-13 x 1 3/4 hex bolts (items 6, 9 and 4) and two 3/8-16 x 1 hex bolts, lock washer with nutplates (items 7, 8 and 5), and bolt the rest of the baseplate to the frame..



8. Using two 1/2-13 x 1 3/4 hex bolts, lock washers, and nutplates (items 6, 9 and 3) bolt the vertical side flats of the baseplate using existing holes on the vehicle, one on each side. **Note: (1) Don't tighten completely. (2) The headlights may have to be taken out.** Once all four 1/2-13 bolts are started, then tighten the bottom bolts, then the side bolts on both sides.



10. The plastic piece that was taken off at the beginning of the install, needs to be trimmed. About 2 inches needs to be trimmed on each side as shown above.



Strong As An Ox™



11. The plastic triangular gussets on the trim piece will also need to be trimmed on each side as shown above.



12. The above photo shows the trim piece installed after being trimmed.

13. The dimensional variations between otherwise identical cars can be considerable. While the location and size of the holes in the baseplate were designed to allow for easy installation, it may be necessary to file a hole slightly to allow a bolt to clear.

14. Install the tow bar and safety cables according to the instructions included in their packages.

15. Do **not** substitute other devices if the tow bar pin and clip are lost.

16. DEALER OR INSTALLER: BE CERTAIN THE USER RECEIVES THE INSTRUCTION SHEET.





Strong As An Ox™

Tools Required

9/16, 3/4 Sockets
8MM, 12MM Sockets

Loctite Blue

17/32" Drill Bit
13/32" Drill Bit

Parts List

Ref. No.	Qty.	Part No.	Description
1	1	61-5880	Weldment, Base Plate, BX4002
2	2	62-3468	Assy, Att. Tab, Rem., SF/SB
3	2	61-3799	Weldment, Nut Plate
4	4	61-5237	Nut Plate, 1/2 Inch
5	2	61-5208	Weldment, Nut Plate, BX3301
6	6	201-0068	1/2-13 x 1 3/4 Hex Bolt, Grd.5, ZP
7	2	201-0443	3/8-16 x 1 Hex Bolt, Grd.5, ZP
8	2	203-0010	3/8 Lock Washer, ZP
9	6	203-0012	1/2 Lock Washer, ZP
10	2	201-0979	#12-14 x 1" Self Drilling Screw, ZP
11	2	101-5822	Adapter, 4-Way Connector
12	2	201-0192	#10-32 x 1/2 Slot, Rd. Hd Screw
13	2	202-0047	#10-32 Hex Nut, ZP
14	2	203-0054	#10 Lock Washer, ZP
	2	226-0046	Baseplate Safety Cable, 36" CL III (Not Shown)
	2	229-0359	Quicklink, 3/8, ZP (Not Shown)
	2	290-0437	Receiver, Cap Plug (BLK) (Not Shown)

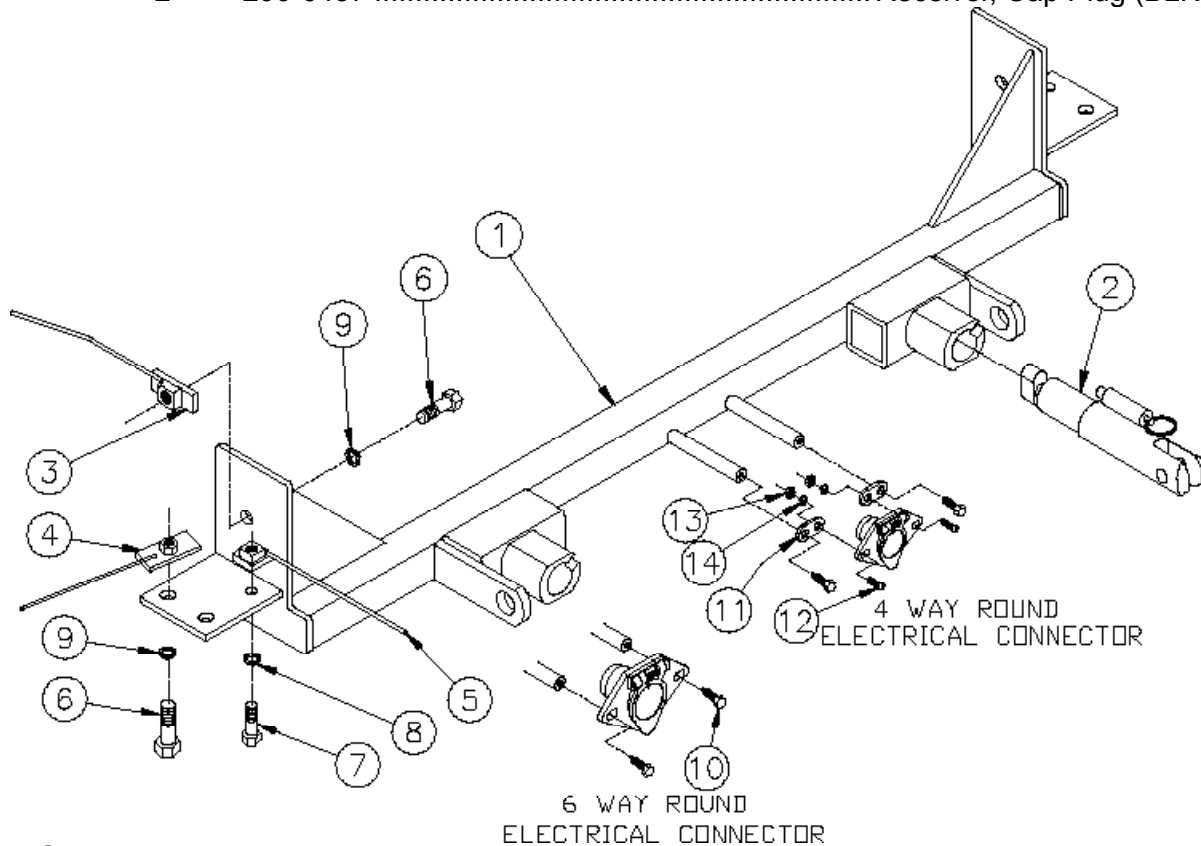

IMPORTANT: Use only genuine factory replacement parts on your Base Plate. Do not substitute homemade or nontypical parts. If a bolt is lost or in need of replacement, for your safety and the preservation of your Base Plate, be sure to use a replacement bolt of the same grade (Usually Grade 5, refer to parts list). Repair parts may be ordered through your nearest **Blue Ox** dealer or distributor.

General Information

1. Ensure that your product(s) are registered online at www.blueox.com. It is crucial to register your product(s) so that you may be alerted of product offerings, updates, upgrades, maintenance and safety bulletins, and/or recalls.
2. **It is the owner's responsibility to inspect all towing equipment for cracked welds, missing or worn parts and loose bolts before each towing trip.** Be sure to use Loctite® Red on all bolts and tighten to the recommended specifications.
3. **It is the owner's responsibility to hook up all towing equipment per manufacturer's instructions/recommendations.**
4. Remove the attachment tabs when not in use (if applicable).

Notice To Baseplate Installer

1. It is YOUR responsibility to watch for:

- Oil cooler and air conditioner lines
- Electrical wires and hoses
- Missing parts or attaching points on the frame

** If the baseplate is improperly installed and is against a wire or hose, it could cause fluid leaks or electrical shorts some time after the actual baseplate installation.

Permanent Baseplate Safety Cable Installation

Permanent baseplate safety cables are strongly recommended when towing a vehicle with a tow bar. The principle function of the permanent baseplate safety cables is to prevent the towed vehicle from breaking loose in the event the connection between the frame of the towed vehicle and the baseplate fails or becomes disconnected. The cables must be connected from the baseplate to the frame rail or cross member of the vehicle's frame. The illustrations below show the possible arrangements recommended by Blue Ox®. Each permanent baseplate safety cable must have an adequate weight rating for the towing system. The weight rating of the two (2) cables together will not qualify.

Do not mount the permanent baseplate safety cables against wires, hoses or brake lines.

These permanent baseplate safety cables should remain installed as long as the baseplate is installed on the vehicle. Permanent baseplate safety cables are to be used in conjunction with, and NOT a replacement for legally required safety cables attaching the towed vehicle to the towing vehicle.

OPTION #1

Permanent Baseplate Safety Cables to Cross Member or Frame of Towed Vehicle.

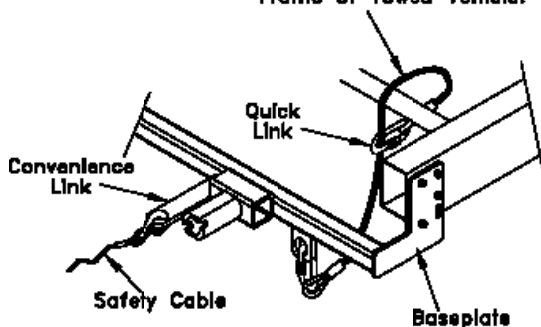

OPTION #2

Permanent Baseplate Safety Cables to Cross Member or Frame of Towed Vehicle.

