

Tools Required

Torax T40
1" Hole Saw
Utility Knife

9/16" Wrench
13/32" Drill Bit

9/16" Socket
Drill

Parts List

| Ref.No. | Qty. | Part No. | Description |
|---------|------|----------------|---|
| 1 | 1 | 61-4912 | Cross Tube |
| 2 | 1 | 61-4913 | Passenger Side Frame Mount |
| 3 | 1 | 61-4914 | Driver Side Frame Mount |
| 4 | 2 | 202-0003 | 3/8 - 16 Hex Nut |
| 5 | 2 | 203-0003 | 3/8 - 16 Flat Washer |
| 6 | 4 | 201-0440 | 3/8 - 16 x 1 1/2 Hex Bolt Grade 5 |
| 7 | 8 | 61-4902 | Weldment, 3/8 Nut w/ 14 Wire |
| 8 | 12 | 203-0010 | 3/8 Lock Washer |
| 9 | 8 | 201-0368 | 3/8 - 16 x 1 1/4 Hex Head Bolt, Grade 5 |
| | 2 | 226-0046 | Baseplate Safety Cable, 36" CL III (Not Shown) |
| | 2 | 229-0359 | Quicklink, 3/8, ZP (Not Shown) |

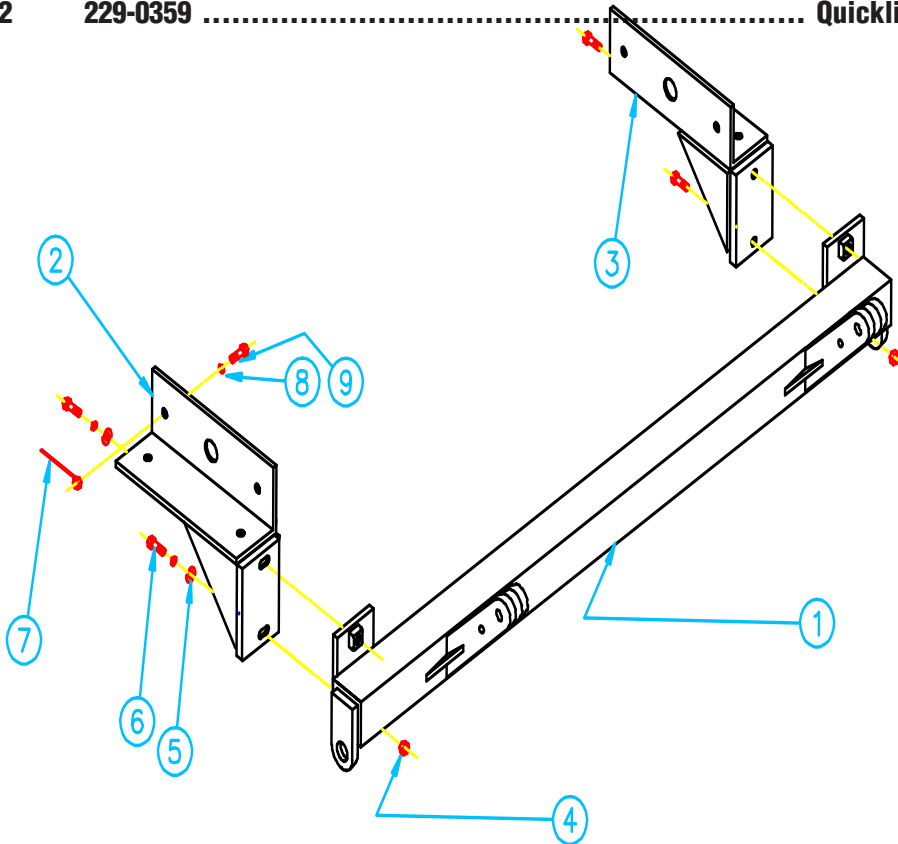



BX2127 Installation Instructions 1992-97 Ford Aerostar

This vehicle weighs over 3500 lbs and requires a Class III (5000 lb) rated tow bar, hitch, and accessories. Utilization of Blue Ox baseplates with any tow bar not approved by Automatic Equipment Mfg. Company invalidates the limited warranty.

Installation of this baseplate requires removing the bumper and drilling holes in the vehicle's frame rails. The air dam and the bottom lip on the bumper will need to be notched.

- 1. Read the General Instruction Sheet included with this baseplate.**
- 2. The baseplate bolts to the frame using eight bolts provided.**
- 3. Using the torax driver, remove the seven bolts (three on the front and four on the bottom) that hold the plastic bumper to the van. Pull the bumper forward and remove from the van.**
- 4. Behind the bumper there are two frame rails. The rails are made of corrugated sheet metal. The frame mounts will bolt to the outside and bottom of the frame rails. To locate the frame mounts, hold them in position and slide them as far forward as possible. The top outside corner of the mount should hit the back of the bumper. Slide the frame mounts back about 3/4" until the two 3/8" bolt holes align with the tops of the frame's corrugation. Mark the four 3/8" holes and the 1" hole and set the frame mount aside. Repeat the procedure for the opposite side.**
- 5. Drill the five holes on each side. Use a 13/32" bit for the bolt holes and a 1" hole saw for the 1" access hole.**
- 6. Bolt the frame mounts to the frame. Use the nut wires on the inside of the frame and put lock washers under the heads of the bolts. Be sure to use Loctite and tighten all four bolts completely after they are started.**
- 7. Place the bumper back in its mounted position. When the cross tube is installed, it will sit in front of the black plastic air dam. The air dam will have to be notched to allow the cross tube to bolt to the frame mounts. On some vehicles the bottom lip on the bumper may have to be notched as well. The notch will be just slightly wider than the frame mounts and as high up as the colored part of the bumper. Mark the notch position on the bumper and then remove the bumper and cut the notches.**
- 8. With the notches properly cut, install the bumper. Use the remaining 3/8" hardware to mount the cross tube to the frame mounts. Use flat washers over the slotted holes and put Loctite on all nuts. When all bolts are started, tighten completely.**
- 9. The dimensional variations between otherwise identical cars can be considerable. While the location and size of the holes in the baseplate were designed to allow for easy installation, it may be necessary to file a hole slightly to allow a bolt to clear.**
- 10. Install the tow bar and safety cables according to the instructions included in their packages.**
- 11. Do not substitute other devices if the tow bar pin and clip are lost.**
- 12. DEALER OR INSTALLER: BE CERTAIN THE USER RECEIVES THE INSTRUCTION SHEET.**

Automatic