



**BX3725 Installation Instructions  
1993-97 Geo Prizm  
1993-97 Toyota Corolla**

**Installation of this baseplate requires removing the plastic belly pan and drilling holes in the tie down brackets of the vehicle.**

- 1. Read the General Instruction Sheet included with this baseplate.**
- 2. The baseplate mounts to the front underside of the car using ten (10) bolts which are supplied.**
- 3. Just behind and below the bumper are two plastic belly pans. They are bolted to the frame and the center engine support. Using a 10mm wrench, remove both belly pans and set them aside. Save the bolts, they will be used to replace the belly pan. Note that some bolts have coarse threads like a wood screw. You will need to replace the screws in the holes they were removed from.**
- 4. Place a jack under the center engine support and put a slight up pressure on the support. Remove the two bolts which attach the support to the front frame. The bolts will not be used in the installation.**
- 5. With an assistant, hold the baseplate up under the car. The side plates on either end of the baseplate should slide inside the tie down brackets on each end of the front frame. Start two bolts through the center support of the baseplate and into the front frame where you removed the two bolts in Step 4.**
- 6. Note that the side plates are shaped to fit against the inside of the tie downs. Above and behind the tie downs is a sheet metal flange. The mounts with the two 5/16" holes should fit up against the bottom of this flange. Holes will need to be drilled in the tie down and the flange to mount the baseplate.**
- 7. Hold the baseplate up as close to its proper position as possible. Using a transfer punch mark the locations in the tie downs for the holes. If the baseplate fits snugly between the tie downs you can mark the holes in the flange at this time. If the baseplate will be pulled wider when the side plates are bolted to the tie downs wait to mark the flange holes until the tie down holes have been drilled and the side plates bolted to the tie downs.**
- 8. Remove the baseplate and drill the marked holes. The large hole in the side plate is 1/2" the smaller hole is 3/8". Use of a pilot drill will make the finished hole smoother and more accurate.**
- 9. When all the holes are drilled, you are ready to mount the baseplate. The center mount on the baseplate should be spaced down from the engine mount. Eight (8) 3/8" washers (4 per bolt) have been supplied for this purpose.**
- 10. Install all the bolts and apply Loctite. When all the bolts align tighten securely.**
- 11. The dimensional variations between otherwise identical cars can be considerable. While the location and size of the holes in the baseplate were designed to allow for easy installation, it may be necessary to file a hole slightly to allow a bolt to clear.**
- 12. Install the tow bar and safety cables according to the instructions included in their packages.**

13. Do not substitute other devices if the tow bar pin and clip are lost.
14. DEALER OR INSTALLER: BE CERTAIN THE USER RECEIVES THE INSTRUCTION SHEET.

### Tools Required

10mm Wrenches	14mm Wrenches	17mm Wrenches
1/2" Wrenches	9/16" Wrenches	3/4" Wrenches
5/16" Drill Bit	3/8" Drill Bit	1/2" Drill Bit
5/16" Transfer Punch	3/8" Transfer Punch	1/2" Transfer Punch
Loctite Red		

### Parts List

Ref. No.	Qty.	Part No.	Description
1	1	61-3932	Weldment, Baseplate, BX3725
2	4	201-0469	5/16-18 x 1 Hex Bolt, Grade 5
3	4	203-0009	5/16 Lock Washer
4	4	202-0002	5/16-18 Hex Nut
5	2	201-0368	3/8-16 x 1 1/4 Hex Bolt, Grade 5
6	2	203-0010	3/8 Lock Washer
7	8	203-0003	3/8 Flat Washer
8	2	202-0003	3/8-16 Hex Nut
9	2	201-0495	10mm-1.25 x 45mm, Grade 8.8
10	2	203-0104	10mm Lock Washer
11	2	201-0011	1/2-13 x 1 1/4 Hex Bolt, Grade 5
12	2	203-0012	1/2 Lock Washer
13	2	202-0005	1/2-13 Hex Nut
	2	226-0046	Baseplate Safety Cable, 36" CL III (Not Shown)
	4	229-0359	Quicklink, 3/8, ZP (Not Shown)

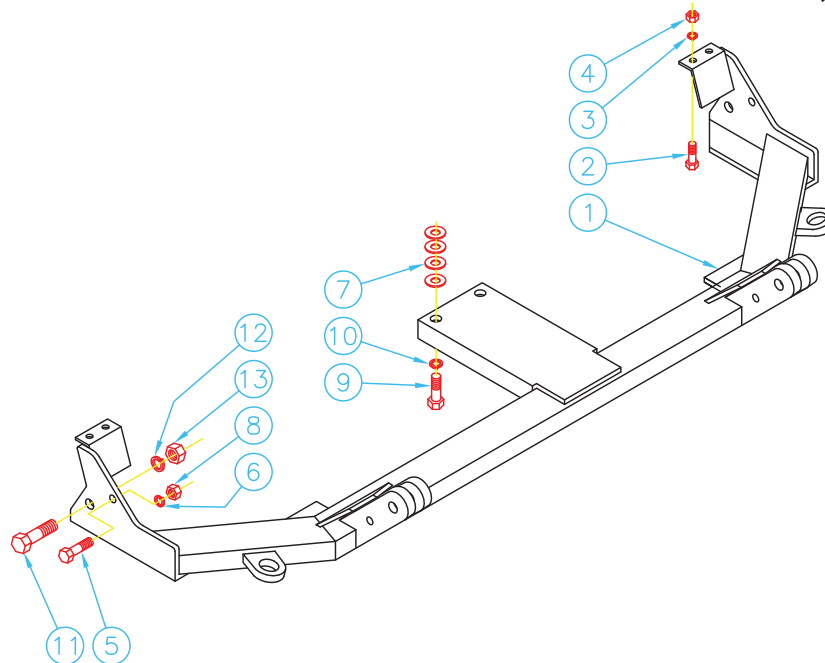

**IMPORTANT:** Use only genuine factory replacement parts on your Base Plate. Do not substitute homemade or non-typical parts. If a bolt is lost or in need of replacement, for your safety and the preservation of your Base Plate, be sure to use a replacement bolt of the same grade (Usually Grade 5, refer to parts list). Repair parts may be ordered through your nearest Blue Ox dealer or distributor.

# General Information

1. Ensure that your product(s) are registered online at [www.blueox.com](http://www.blueox.com). It is crucial to register your product(s) so that you may be alerted of product offerings, updates, upgrades, maintenance and safety bulletins, and/or recalls.
2. **It is the owner's responsibility to inspect all towing equipment for cracked welds, missing or worn parts and loose bolts before each towing trip.** Be sure to use Loctite® Red on all bolts and tighten to the recommended specifications.
3. **It is the owner's responsibility to hook up all towing equipment per manufacturer's instructions/recommendations.**
4. Remove the attachment tabs when not in use (if applicable).

## Notice To Baseplate Installer

1. **It is YOUR responsibility to watch for:**

- Oil cooler and air conditioner lines
- Electrical wires and hoses
- Missing parts or attaching points on the frame

\*\* If the baseplate is improperly installed and is against a wire or hose, it could cause fluid leaks or electrical shorts some time after the actual baseplate installation.

## Permanent Baseplate Safety Cable Installation

Permanent baseplate safety cables are strongly recommended when towing a vehicle with a tow bar. The principle function of the permanent baseplate safety cables is to prevent the towed vehicle from breaking loose in the event the connection between the frame of the towed vehicle and the baseplate fails or becomes disconnected. The cables must be connected from the baseplate to the frame rail or cross member of the vehicle's frame. The illustrations below show the possible arrangements recommended by Blue Ox®. Each permanent baseplate safety cable must have an adequate weight rating for the towing system. The weight rating of the two (2) cables together will not qualify.

***Do not mount the permanent baseplate safety cables against wires, hoses or brake lines.***

These permanent baseplate safety cables should remain installed as long as the baseplate is installed on the vehicle. Permanent baseplate safety cables are to be used in conjunction with, and NOT a replacement for legally required safety cables attaching the towed vehicle to the towing vehicle.

### OPTION #1

Permanent Baseplate Safety Cables to Cross Member or Frame of Towed Vehicle.

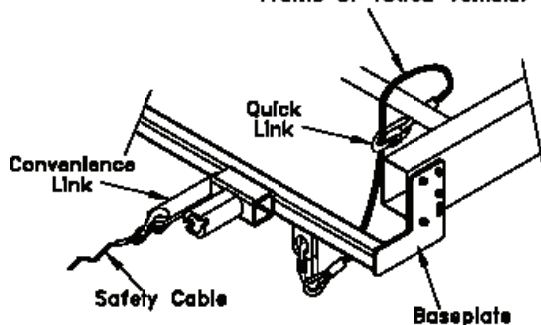

### OPTION #2

Permanent Baseplate Safety Cables to Cross Member or Frame of Towed Vehicle.

